



Village of Palm Springs

226 Cypress Lane
Palm Springs, FL 33461
Phone (561) 965-4016 Fax (561) 439-4132
www.vpsfl.org

LIFE SAFETY PLAN REVIEW APPLICATION

Application Number: _____ Application Date: _____

Owner Builder/Contractor: _____

Phone: _____ Fax: _____

Project Street Address: _____

Proposed Review: _____

I understand a fee may be charged for this review in accordance with the Village of Palm Springs construction permit fee schedule. The fee is required to be paid at the time of pick-up. I understand all review dealing with the project must be clearly indicated on the submitted plans.

Signed: _____

OFFICIAL USE ONLY

Hours _____ X \$30.00/hr. = \$ _____

Administrative Fee = \$ 20.00

Total = \$ _____

Receipt Number: _____ Balance Due: _____

Zoning Review: _____ Plans Examiner: _____

104.2.7 Notice of termite protection. A permanent sign which identifies the termite treatment provider and need for re-inspection and treatment contract renewal shall be provided. The sign shall be posted near the water heater or electric panel.

104.3 Examination of documents

104.3.1 Plan review. The building official shall examine or cause to be examined each application for a permit and the accompanying documents, consisting of drawings, specifications, computations and additional data, and shall ascertain by such examinations whether the construction indicated and described is in accordance with the requirements of the technical codes and all other pertinent laws or ordinances.

Exceptions:

1. Building plans approved pursuant to s. 553.77(6) Florida Statutes and state-approved manufactured buildings are exempt from local codes enforcing agency plan reviews except for provisions of the code relating to erection, assembly or construction at the site. Erection, assembly and construction at the site are subject to local permitting and inspections.
2. Industrial construction on sites where design, construction and fire safety are supervised by appropriate design and inspection professionals and which contain adequate in-house fire departments and rescue squads is exempt, subject to local government option, from review of plans and inspections, providing owners certify that applicable codes and standards have been met and supply appropriate approved drawings to local building and fire-safety inspectors.

104.3.1.1 Minimum plan review criteria for buildings. The examination of the documents by the building official shall include the following minimum criteria and documents; a floor plan, site plan, foundation plan, floor/roof framing plan or truss layout and all exterior elevations:

Commercial Buildings: Building

1. Site Requirements
 - parking
 - fire access
 - vehicle loading
 - driving/turning radius
 - fire hydrant/water supply/Post Indicator Valve (PIV)
 - set back/separation (assumed property lines)
 - location of specific tanks, water lines and sewer lines

2. Occupancy group and special occupancy requirements shall be determined.
3. Minimum type of construction shall be determined (Table 500)
4. Fire resistant construction requirements shall include the following components:
 - fire resistant separations
 - fire resistant protection for type of construction
 - protection of openings and penetrations of rated walls
 - fire blocking and draftstopping
 - calculated fire resistance
5. Fire suppression systems shall include:
 - early warning
 - smoke evacuation systems schematic
 - fire sprinklers
 - standpipes
 - pre-engineered systems
 - riser diagram
6. Life Safety systems shall be determined and shall include the following requirements:
 - occupant load and egress capacities
 - early warning
 - smoke control
 - stair pressurization
 - systems schematic
7. Occupancy Load/Egress Requirements shall include
 - occupancy load
 - gross
 - net
 - means of egress
 - exit access
 - exit
 - exit discharge
 - stairs construction/geometry and protection doors
 - emergency lighting and exit signs
 - specific occupancy requirements
 - construction requirements
 - horizontal exits/exit passageways
8. Structural requirements shall include:
 - soil conditions/analysis
 - termite protection
 - design loads
 - wind requirements
 - building envelope
 - structural calculations (if required)
 - foundation
 - wall systems
 - floor systems
 - roof systems
 - threshold inspection plan
 - stair systems

100110
Fire Extinguisher

Men's mannequin Display Women's mannequin Display

REQUIRE FOR ALL INSPECTIONS CALL 434-5092

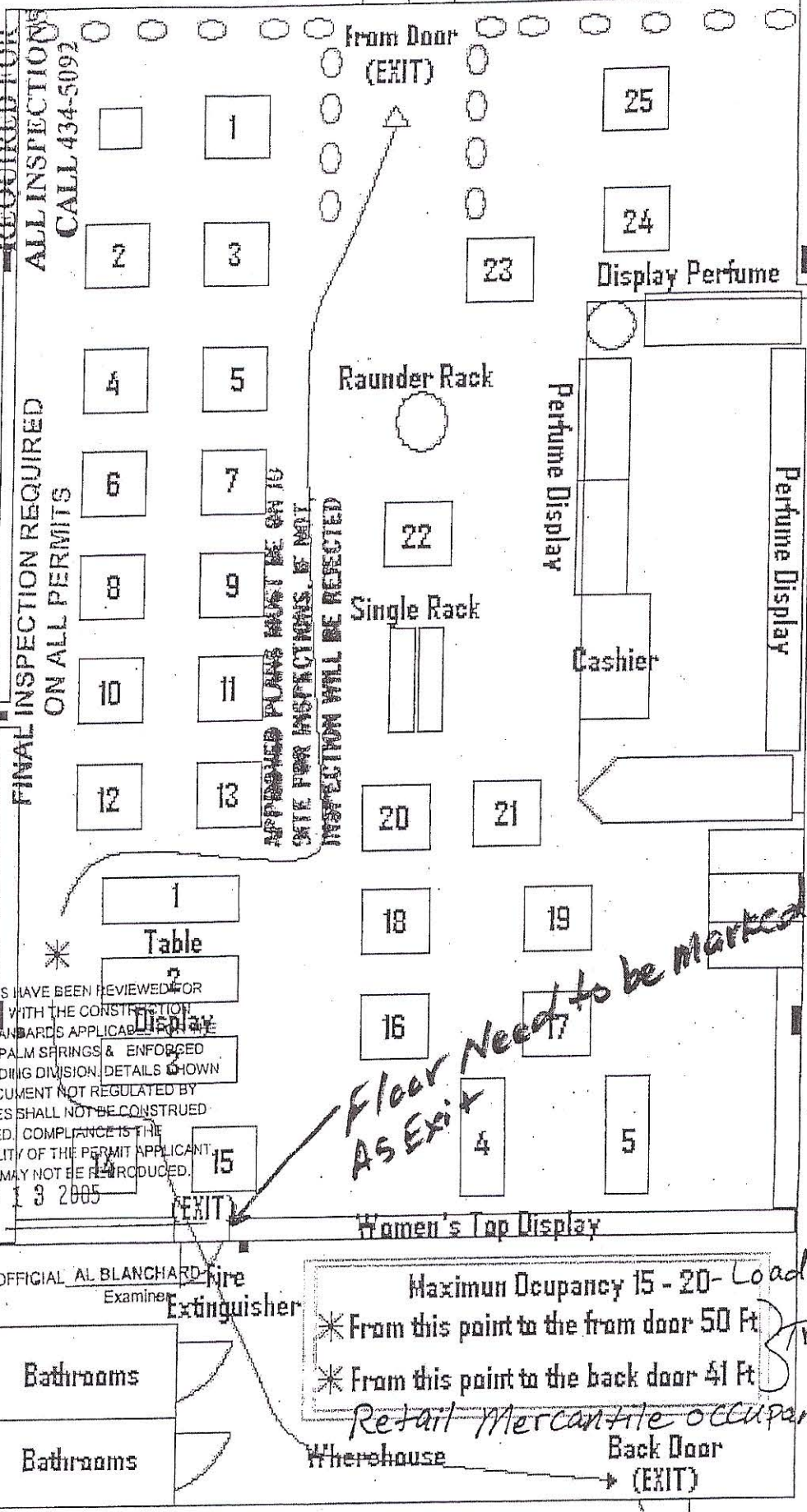

FINAL INSPECTION REQUIRED ON ALL PERMITS

APPROVED PLANS MUST BE ON IS DATE FOR INSPECTIONS. IF NOT, INSPECTION WILL BE REJECTED

ALL PLANS HAVE BEEN REVIEWED FOR COMPLIANCE WITH THE CONSTRUCTION CODES & STANDARDS APPLICABLE TO THE VILLAGE OF PALM SPRINGS & ENFORCED BY THE BUILDING DIVISION. DETAILS SHOWN ON THIS DOCUMENT NOT REGULATED BY THESE CODES SHALL NOT BE CONSTRUED AS APPROVED. COMPLIANCE IS THE RESPONSIBILITY OF THE PERMIT APPLICANT. THIS STATEMENT MAY NOT BE REPRODUCED.

DATE & PERMIT NO. OFFICIAL AL BLANCHARD Fire Examiner

Bathrooms

Maximum Occupancy 15 - 20 - Load
* From this point to the front door 50 Ft
* From this point to the back door 41 Ft
Retail Mercantile occupancy
Warehouse Back Door (EXIT)

Inspection Required by the Fire marshal
C/O Inspection Required -
Electrical Sub Permit Required by separate permit w/ Electrician

Women's shoes Display
Emergency Light

Emergency Light

Fire Extinguisher